



# Thermal Catheter Bonder

## Fast and LEAN



Astute Design's Thermal Catheter Bonder is the embodiment of LEAN principles. The highly versatile and robust catheter bonding machine consumes less than one square foot of expensive cleanroom table workspace. The efficient thermal heaters and novel thermal bonding jaws have been designed to allow quick changeover from one catheter size to another while providing exact process control of the thermal bonding process. The design of this Thermal Catheter Bonder eliminates tedious height adjustments and allows the operator to work at a comfortable height. Its user interface is simple and straightforward (just one main control screen) and the Thermal Catheter Bonder incorporates an attractive, Hi-Tech design.



### Features:

- o Dual Clamp Buttons: Clamp either side individually or when the bonding cycle is initiated.
- o Dual Start Buttons: either button or a foot pedal can be used to initiate the bonding cycle.
- o Quick Change Bonding Die enables SMET® (Single Minute Exchange of Tooling) once the dies have cooled.
- o Dual Precision Clamp Pressure Adjust Regulators: Individually adjust the catheter or tip clamp pressure.
- o Dual Precision Clamp Pressure Gauges allow for consistent and repeatable processing.
- o Laser Pointer enables even novice operators to precisely and repeatably position the bond.
- o True Smart Controller provide nearly infinite (Incremental) adjustments of Bond Temperature, Push Speed, Push Distance and Bond Time (within machine limits).
- o 20 different recipes can be stored simultaneously.
- o E-Stop removes all energy sources from machine.
- o Soft Silicone Clamp Grips prevent damage while ensuring minimal slippage.
- o Powerful Stepper Motor provides sufficient force to bond even high durometer materials.

### Other Astute Products



Roller Braided Catheter Cutter



Thermal Tipper



Non-Braided Catheter Cutter

## THERMAL BONDER SPECIFICATIONS:

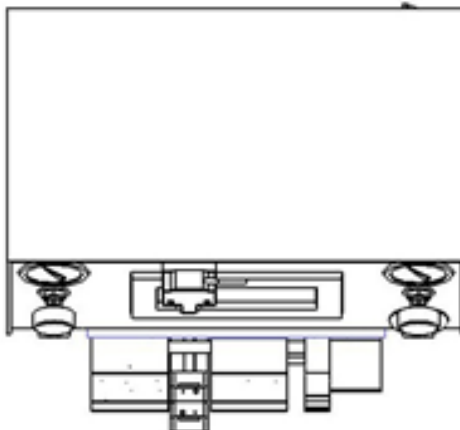
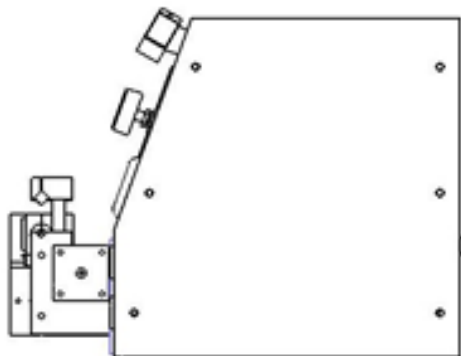
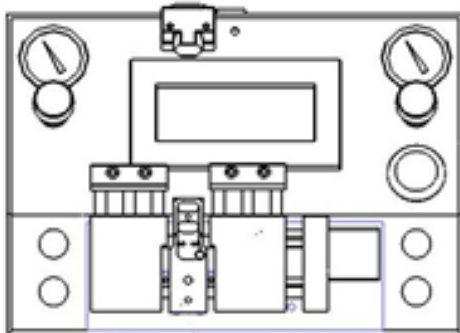
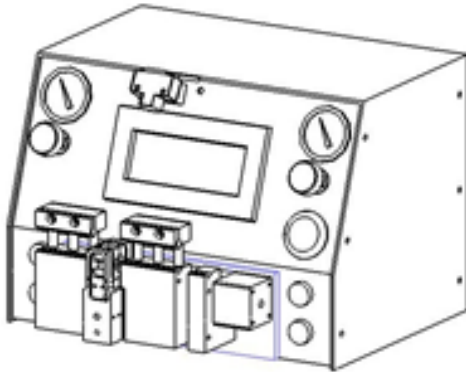

### UTILITIES:

110 VAC, 60 Hz, 5 A  
40 to 60 PSI, 1 um Filtered, Dry Air  
Dim: 12" x 12" x 9" (305 x 305 x 216mm)

### FEATURES:

4 to 15 Fr Bonding  
Programmable Temperature to 250°C (480°F)  
Shaft Clamping Force of 1-25 lbs (@ 30 psi)  
Cooling Jets (pressure externally regulated)  
Programmable Preheat, Push & Cool Times  
21 Program Capacity (1 default + 20 user defined)  
Dual (front & back) Hi-Power 60W Heaters  
Individual RTD sensors tightly control process  
Hi force stepper motor bonds most polymers  
Quick change die require no re-wiring  
Dual illuminated Clamp & Start buttons  
Easy to remove Safety Shield (not shown)  
Adjustable laser pointer joint alignment  
Easy to read, touch screen HMI  
Password protected recipes  
Externally accessible 5A fuse  
Machine directed recipe changeovers  
User selectable IDLE mode to save energy  
E-Stop removes all energy from machine  
Simple, one page operator interface  
Recipes are quantifiable and easily validatable  
Bonder creates very high first pass yields  
Machine can form either lap or butt joints

### ACCESSORIES:

Custom design and fabricated bonding die  
Foot pedal for "hands free" cycle start